

Indigenous People’s Task Force

Awards and Recognitions:

- 2013 Executive Director received Alston Bannerman Award for Activists of Color
- 2009 IPTF Executive Director honored by NGLTF for her work with women and HIV
- 1998 National Native American AIDS Prevention Resource Center special recognition for IPTF’s commitment to preventing HIV among Native youth
- 1996/1997 IPTF staff participated in White House health conferences
- 1995 Health Care Financing Administration Administrator’s Achievement Award from the U.S. Department of Health and Human Services
- 1994 U.S. Surgeon General’s Award for Excellence Office for its work in youth HIV/AIDS prevention and health education

Mikwanedun Audisookon Capital Campaign Committee:

- | | |
|---------------|------------------|
| Susan Allen | Denise Mayotte |
| Karen Clark | Peter McLaughlin |
| Don Crofut | Antony Stately |
| Kelly Drummer | Ann Viitala |
| Ann Manning | Barbra Wiener |

Special Advisors:

- Suzanne Koepplinger
Robert Lilligren

Current programs include:

- Preventative health education in the areas of childhood diabetes and obesity, substance abuse (including commercial tobacco), teen pregnancy, and HIV
- Health related services such as testing and case management for persons with HIV
- Supportive housing for homeless families and individuals with medical disabilities
- Environmental justice organizing and advocacy in water quality and indoor air quality

MIKWANEDUN AUDISOOKON

A center for art and wellness

If you would like to learn more about the **Mikwanedun Audisookon**, make a contribution to the capital campaign, or otherwise help to make this dream a reality, please contact Sharon Day at (612) 870-1723. Thank you.

Remembering our teachings



Indigenous Peoples Task Force

MIKWANEDUN AUDISOOKON

A center for art and wellness

*An urban sanctuary where body, mind and spirit
become whole through indigenous culture and practice*



Indigenous Peoples Task Force
1335 East 23rd Street, Minneapolis, MN 55404
www.indigenouspeoplestf.org

MIKWANEDUN AUDISOOKON

A center for art and wellness

Mik-wane-dun Aud-i-soo-kon means “remember our teachings” in Ojibwe

The **Mikwanedun Audisookon for Art and Wellness** will continue the healing traditions that have been passed down through the generations, providing an urban sanctuary where body, mind, and spirit can become whole through time-honored indigenous culture and practice.

The spacious new center will allow all of IPTF's programming to be expanded and its art and theater programming to be brought under one roof.

Use of indigenous-based building materials and renewable energy systems will result in significantly lower energy and operational costs and reduced environmental impact. Using green building technologies will also create job opportunities and model environmentally responsible choices that respect the health of our earth, air and water.

Mikwanedun Audisookon will represent a multi-million dollar capital investment in the Phillips area, with ongoing program and job training investments of approximately \$360,000 annually – a significant and long-term contribution toward the health, cultural vitality, and economic growth and stability of the Native American and South Minneapolis communities.

A March 2017 groundbreaking is planned with construction completed April 2018.



Multi-functional space will expand opportunities

A new multi-functional space will expand opportunities for art programming and experiential learning and entrepreneurship, including:

- 1 A studio/workshop for training and entrepreneurial development in traditional arts such as cedar box and black ash basket making.
- 2 An intimate theater space that will allow IPTF to expand on its successful Ikidowin Program, a youth theater program used to educate youth on pregnancy prevention. This program currently employs youth through the STEP program.
- 3 A lobby / gallery that will provide space for the exhibition of both traditional and contemporary art and craft, and also provide job training opportunities.
- 4 A commercial kitchen, greenhouse, and garden which will include Native medicine and food plants will provide training and the development of value-added market products based on traditional, healthy foods.

The second floor will be used for IPTF staff offices and workspace.

Projected Impacts

of MIKWANEDUN AUDISOOKON

Increased access to culturally based holistic health education and services:

The center will provide the office and community space IPTF needs to efficiently integrate its health and environmental education, art and theater opportunities, case management services, and housing and traditional healing activities for Native youth and adults.

Training in green building technologies:

Training in green building technologies – largely inaccessible for Indigenous peoples, people of color and low-income people living in Minneapolis – will be provided.

Use of compressed earth block (“CEB”), photo voltaic and geothermal energy, along with water quality best management practices, will provide a “learning laboratory” for vocational trainings in green construction, renewable energy and ecological landscaping.

Certified training and informal workshops in CEB will take place both during and after construction. Certified participants will then receive training as community educators expanding the positive impacts beyond the center.

Increased arts and cultural programming:

The center will house a workshop, studio, gallery and small theater, allowing IPTF to offer hands-on creative opportunities for both youth and adults. IPTF will also expand its popular Ikidowin Program, which uses theater arts to address the issue of teen pregnancy in a peer-to-peer setting.

Improved community safety, economic stability and relationship building:

Inclusiveness and respect for diversity are central tenets of traditional Native American cultures. Though IPTF programs are based in Native values and ways of knowing, they are open to youth and adults of all backgrounds. Mikwanedun Audisookon for Art and Wellness will provide safe space where anyone can restore and renew their relationship with each other and the environment. In addition, the center would help to stabilize adjacent property values and reduce crime through increased foot traffic to and from the Center and the many trainings, programs and projects it would host.

Our Mission

Strengthen the health and education of native peoples.

Indigenous Roots, Expansive Vision



Mikwanedun Audisookon for Art and Wellness will build upon IPTF's experience as an innovative provider of culturally appropriate health education, housing and case management services for Native Americans.

- IPTF's culturally-based, experiential approach to HIV prevention, women's health, tobacco cessation, and childhood obesity-linked diseases are modeled across the state and nation.
- IPTF was the first organization in the nation to provide housing tailored to the needs of Native Americans living with HIV.
- Every year, over 1,000 community members benefit from IPTF health education programs and direct services.
- Safe and affordable housing is provided for 14 homeless families and individuals living with HIV and other medical disabilities.
- With its health education programs for youth, IPTF annually provides job and income generating experience for 50-75 young people from South Minneapolis.
- IPTF's culturally-based, experiential approach has been recognized regionally and nationally for its positive impact on the lives of Native people.
- IPTF attracts and manages \$1 million in federal grant dollars annually.
- In 1997 IPTF successfully managed the design, capital campaign and construction of \$2.1 million Manidoowaydak Odena housing community for Native Americans living with HIV. This project won the MFHA Housing Design of the Year Award and is a community which still thrives today.

More than **1,500 youth and adults** receive testing, attend educational events, or are otherwise engaged by IPTF programming each year.

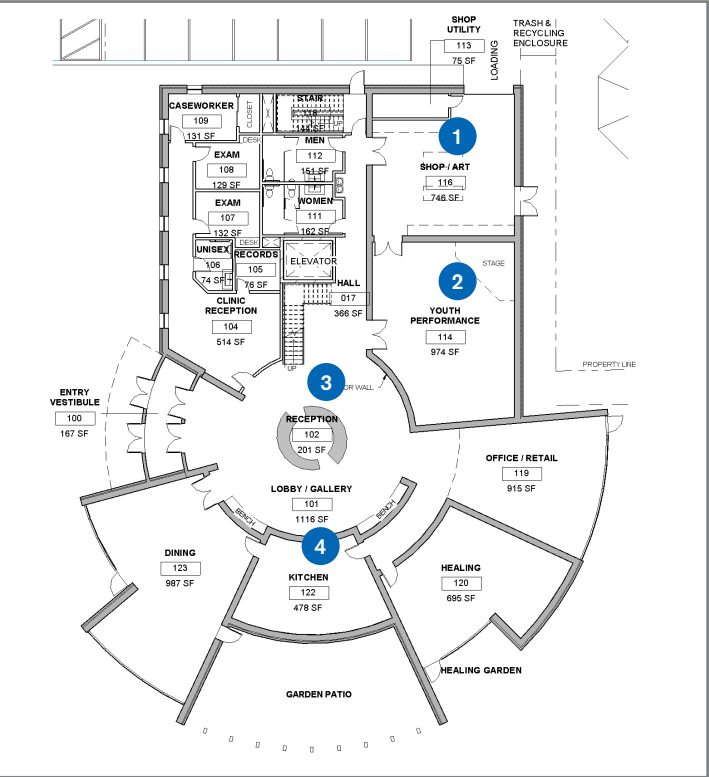

Mikwanedun Audisookon will be located at 24th St. East and 13th Ave. South

